

6

5

4

3

2

1

GENERAL MACHINING TOLERANCE - GRADE MEDIUM (UNI EN ISO 22768)									
TOLLERANZA GENERALE DI LAVORAZIONE - GRADO MEDIO (UNI EN ISO 22768)									
Size	above	Gruppo di dimensioni	oltre	-	6	30	120	400	1000
	up to		fino a		6	30	120	400	1000
Tolerance		Scostamenti		±0.1		±0.2	±0.3	±0.5	±1.2
						±2	±3		

REMOVE SHARP EDGES
TOGLIERE SPIGOLI VIVI

Chamfer 0.5x45° R=0.5
Smusso

A

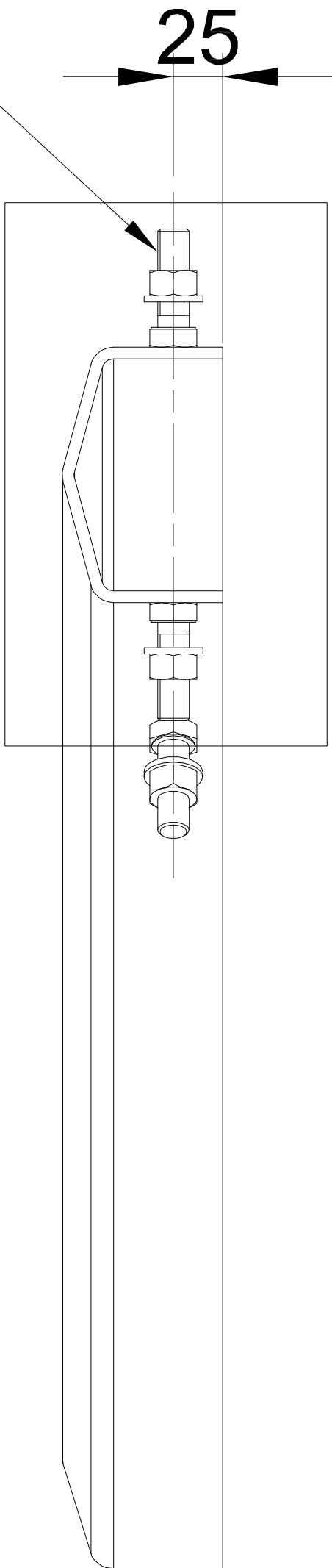

n°4 V.T.E M16
to be welded

Fornire n°4 Dadi M16 UNI5588
e n°4 Rondelle Piane M16 UNI 6592
Provide n°4 nut M16 UNI5588
and n°4 flat washers M16 UNI 6592

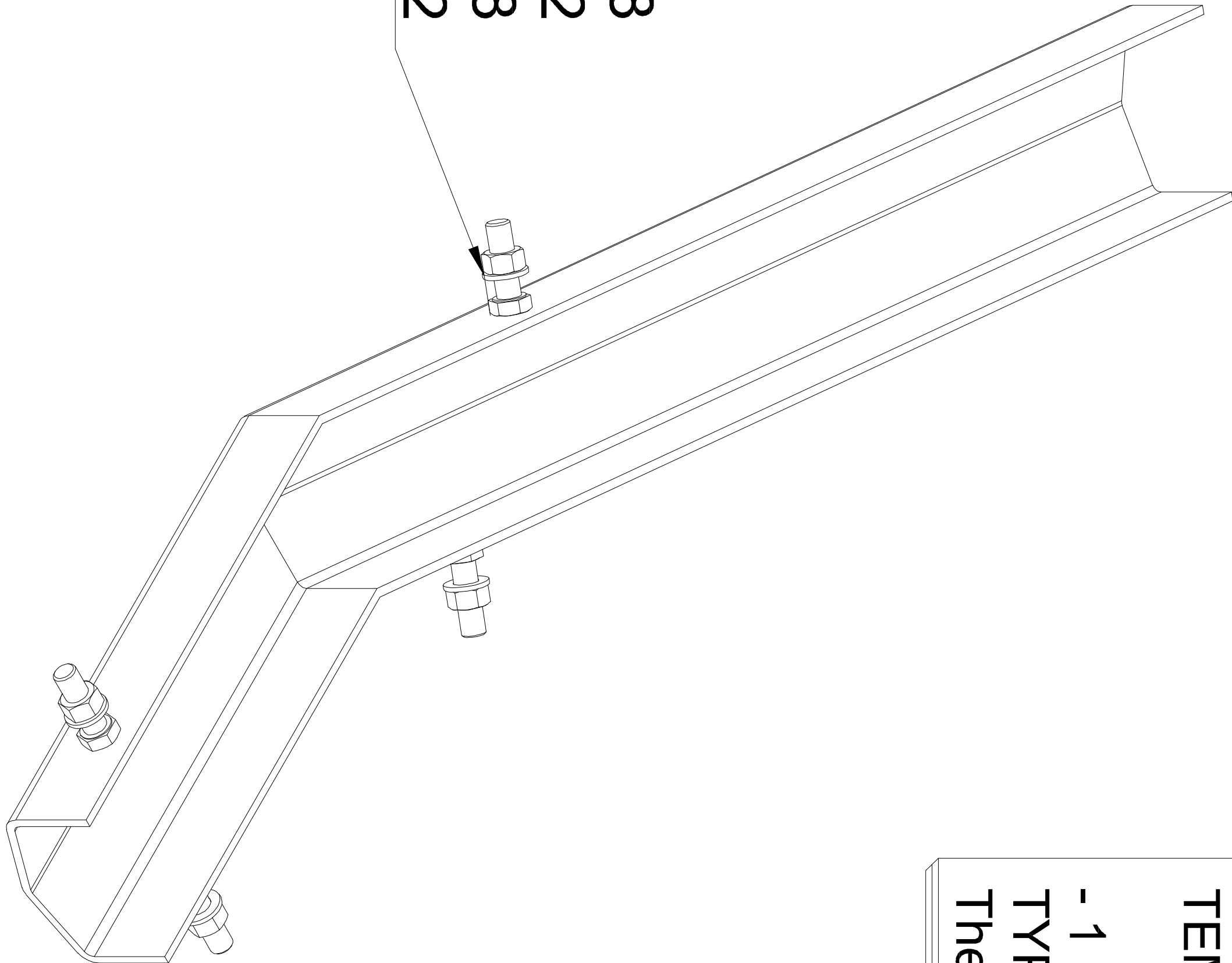

Saldare allo scivolo
Welding to the slide

Saldare allo scivolo
Welding to the slide

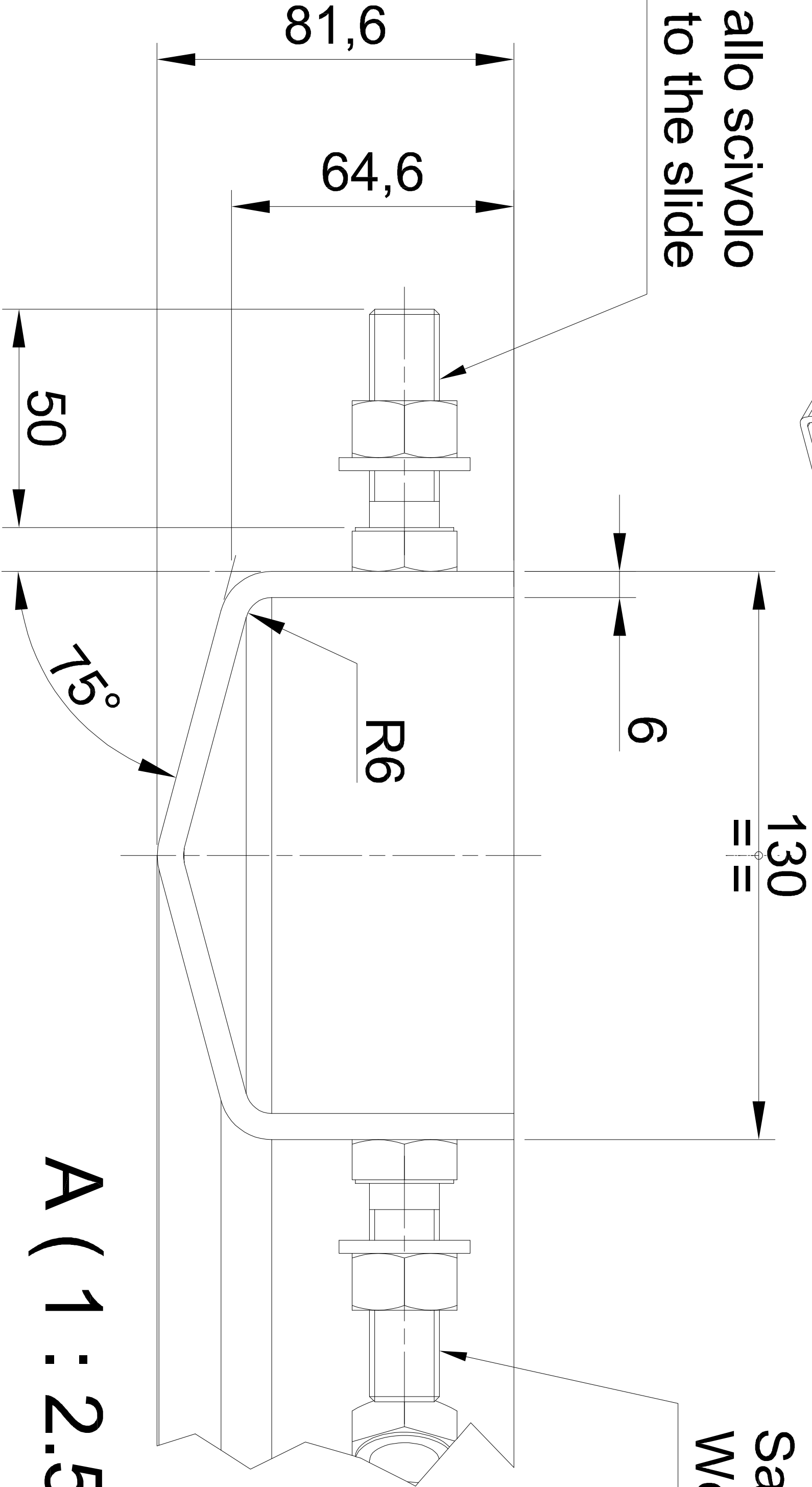

A (1 : 2.5)

HIGH TEMPERATURE PAINTING REGULATIONS (600°C)
Paint the untreated surfaces as follows:
- 1 coat of TWO-COMPONENT INORGANIC ZINC FOR HIGH TEMPERATURES (450°C) TYPE ZINCOSIL (CO.VER.LAC.), 75µm thick.
- 1 or more coats of SILICONE PAINT FOR HIGH TEMPERATURES (600°C) TYPE HTA600 (CO.VER.LAC.), 60µm thick.
The final coat thickness will therefore be no less than 135µm.

NORME GENERALI DI SALDATURA GENERAL RULES FOR WELDED JOINTS

PREPARAZIONE DEI LEMBI SECONDO "DIN 1912"
EDGE PREPARATION FOR WELDING ACCORDING TO
DOVE NON AL TRIMENTI INDICATO - A = 0.7
DELLO SPESSORE MINIMO DA COLLEGARE
WHERE NOT SPECIFIED - A = 0.7
OF THE MINIMUM THICKNESS TO BE JOINT

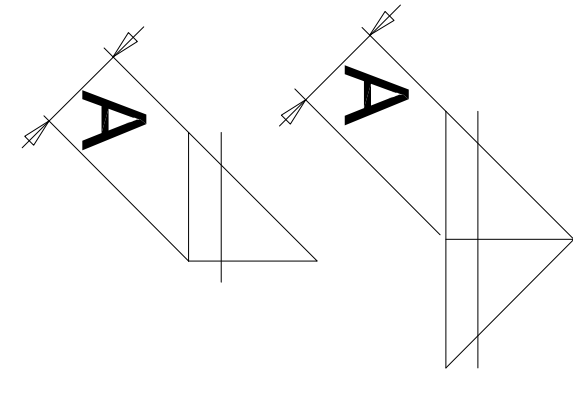

A

B

C

D

A

B

C

D

19/02/2025						
DATA		Q.TA'				
Descrizione:		S.P.	R.V.	R.V.	S235JR EN 10025	16,5 kg
		Disegnato	Verificato	Autorizzato	Materiale	Massa
		Scivolo di scarico				

Sciivolo di scarico (Discharge Chute)

Disegno N.

Scala: 1 : 8

60-19-31A-141

Revisione: 0

Foglio: 1 di 1

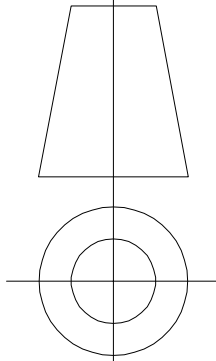
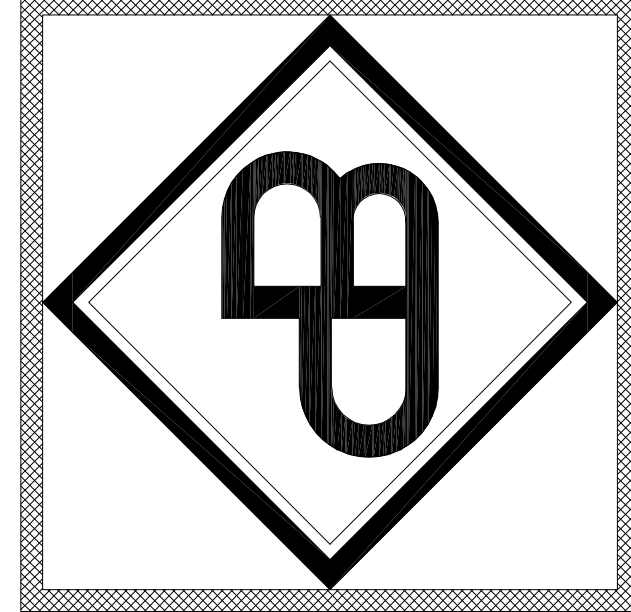

BRUNO PREZZI spa
UFFICIO TECNICO
VALIDO PER COSTRUZIONE

A termine di legge e' rigorosamente vietato riprodurre o comunicare a terzi il contenuto del presente disegno

Via per Orago 8 - BURAGO DI MOLGORA - C.A.P. 20875 (MB) - ITALY
Tel. 039/635021 FAX 039/6081373 - e-mail: bruno.prezzi@brunoprezzi.com

A3